



Color Variants

WM260162
Free-standing, slide-under or stackable
Width 60 cm, height 84.8 cm

WM260162
Washing machine
Free-standing, slide-under or stackable
Width 60 cm, height 84.8 cm

Intelligent dosage system iDos for automatic in-flow control of liquid detergent and softener
9 kg drum with interior lighting
Large porthole with 180 ° door opening angle
Innovative motor technology for more performance, higher durability as well as less energy consumption and noise
Anti-stain automatic for stain specific programme cycles
Can be perfectly combined with WT 260 100
Energy efficiency class A+++ (-30%)

Handling
Electronic control.
Illuminated rotary knob with integrated On-Off switch.
Touch key operation.
TFT display with clear text and symbols.
Loading indicator with dosage recommendation.
Programme sequence and remaining time display.
Time delay up to 24 h hours.
Multiple signal tones.

Features
Aqua sensor.
Aqua stop with guarantee.
Flow-through sensor.
Anti-stain automatic.
Continuous automatic load adjustment.
Foam detection system.
Spin speed selection from 400 to 1600 rpm.
Top-up function.
Automatic stabilisation.
Anti-crease system.
Child lock.

Programmes
Cottons, cold to 90 °C.
Easy care, cold to 60 °C.
Quick/Mix 40 °C.
Delicates/Silk, cold to 40 °C.
Wool, cold to 40 °C.
Lingerie.
Towels.
Automatic.
Hygiene.
Super 15/30.
Textile Guard.
Downs.
Shirts/blouses.
Additional programmes: Curtains, Night programme, Drum clean, Rinse, Spin, Soft Spin, Empty.

Features
Powder detergent drawer with automatic cleaning mode after every wash cycle.
2 iDos tanks with 1.3 and 0.5 l capacity for liquid detergent or softener.
Stainless steel drum with wave structure.
Drum interior lighting.
Volume capacity from 1 to 9 kg.

Product rating
Energy efficiency class A+++ (-30%).
Water consumption 11220 l/year.
Energy consumption 152 kwh/year.

Planning notes
Left-hinged.
Height-adjustable feet.
Height for slide-under installation: 82 cm.

Characteristics
Construction type
Free-standing
Height of removable worktop (mm)
820
Dimensions of the product (mm)
848 x 598 x 632
Net weight (kg)
83.0
Connection rating (W)
2300
Current (A)
10
Voltage (V)
220-240
Frequency (Hz)
50
Approval certificates
, CE, Eurasian, Ukraine grounding sign, VDE
Length of electrical supply cord (cm)
210
Capacity cotton (kg)
9.0
Energy efficiency class
Washing performance class
A
Total annual energy consumption (kWh)
Water consumption (l)
Total annual water consumption (l)
Door hinge
Left
Wheels
No
Power consumption standby/network:
Please check the user manual for how to switch off the WiFi module.
Time auto-standby/network
EAN code
4242006250744

Consumption and connection features
Capacity cotton (kg) - NEW (2010/30/EC)
Energy efficiency class - NEW (2010/30/EC)
A+++
Energy consumption annual (kWh/annum) - NEW (2010/30/EC)
152
Energy consumption (kWh)
Power consumption in off-mode (W) - NEW (2010/30/EC)
0.12
Power consumption in left-on mode - NEW (2010/30/EC)
0.43
Water consumption annual (l/annum) - NEW (2010/30/EC)
11220
Spin drying performance class
A
Maximum spin speed (rpm) - NEW (2010/30/EC)
1552
Average washing time cotton 40C (partial load) - NEW (2010/30/EC)
270
Average washing time cotton 60C (full load) (min) - NEW (2010/30/EC)
275
Average washing time cotton 60C (partial load) - NEW (2010/30/EC)
270
Duration of the left-on mode - NEW (2012/30/EC) (min)
15
Noise level washing (dB(A) re 1 pW)
47
Noise level spinning (dB(A) re 1 pW)
73
Installation type
Built-under

created on 2017-03-16
Page 1

Stackable under the tumble dryer WT 260 100 in combination with special accessory.

Connection
Total connected load 2.3 kW.
Connection cable 2.10 m with plug.
Water connection with 3/4 " screw joint.

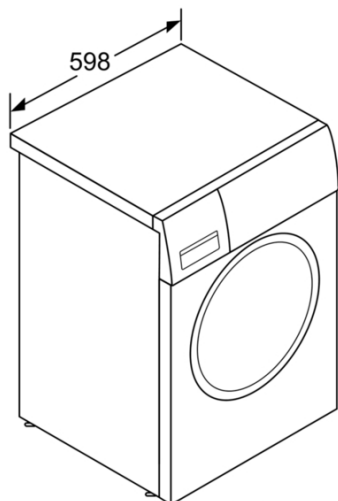

measurements in mm

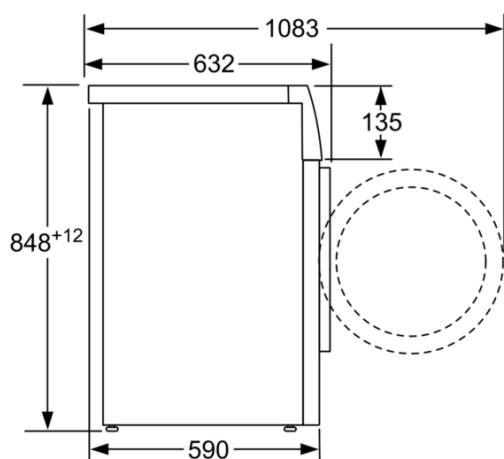

measurements in mm